

## Submittal Data

**System: E18SD3UAW**

Single Zone Heat Pump Ceiling Concealed

Job Name: \_\_\_\_\_  
 Location: \_\_\_\_\_  
 Engineer: \_\_\_\_\_  
 Submitted to: \_\_\_\_\_  
 Submitted by: \_\_\_\_\_  
 Reference: \_\_\_\_\_  
 Approval: \_\_\_\_\_  
 Date: \_\_\_\_\_  
 Construction: \_\_\_\_\_  
 Unit#: \_\_\_\_\_  
 Drawing#: \_\_\_\_\_



CS-E18SD3UAW



CU-E18SD3UA

## OUTDOOR UNIT DIMENSIONS

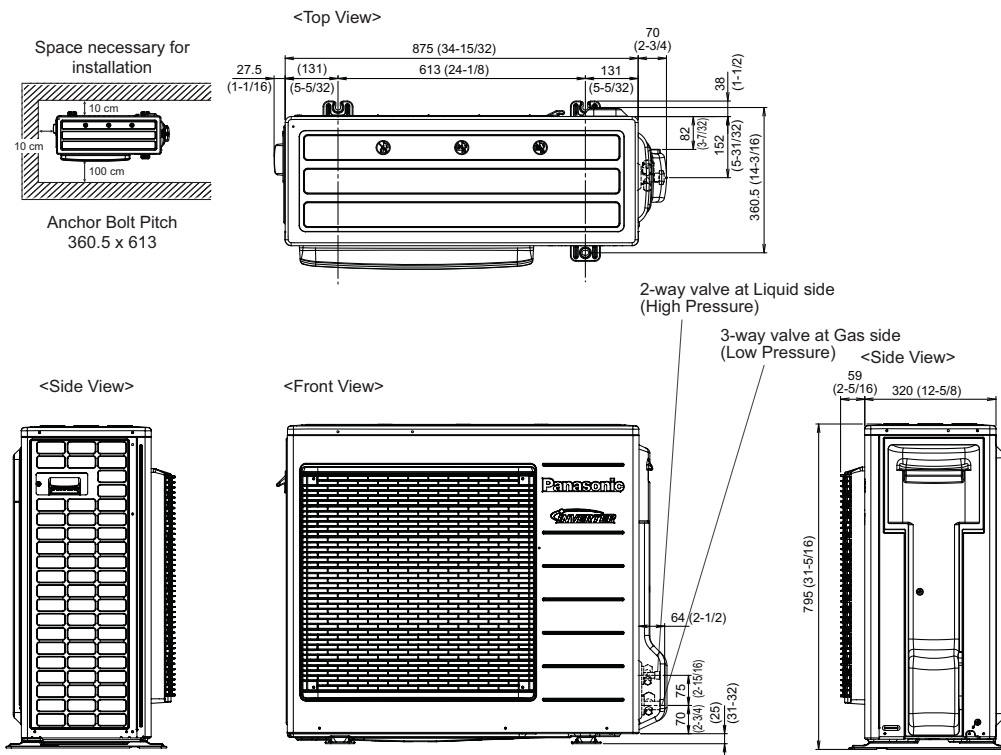

Unit: mm/inch

# INDOOR UNIT DIMENSIONS

<Front View>

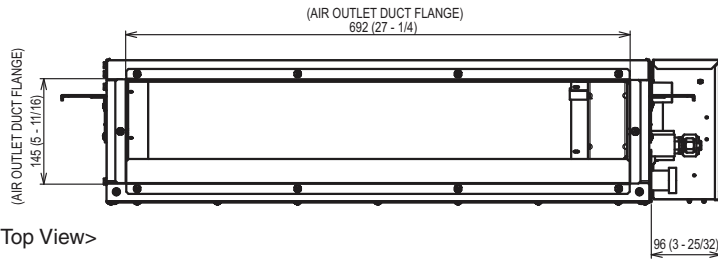

<Top View>

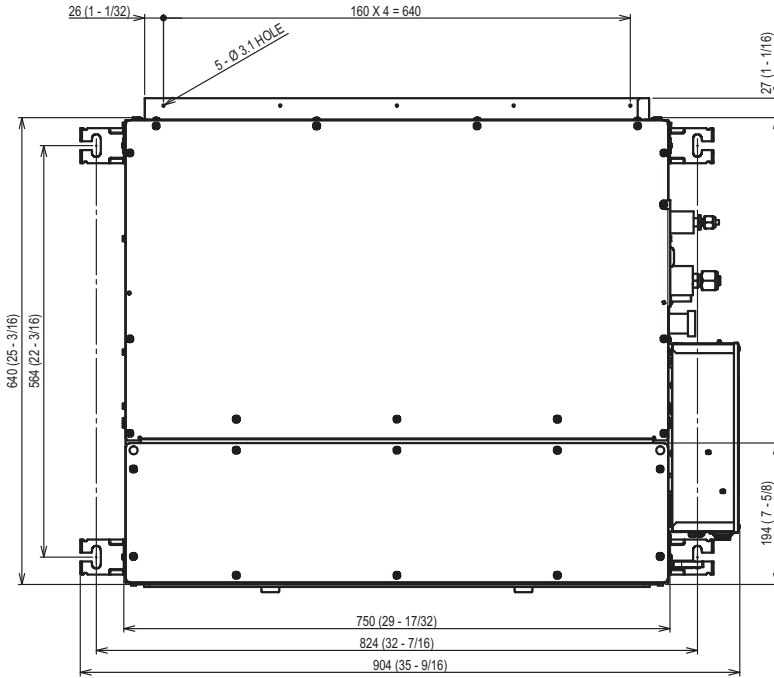

<Side View>

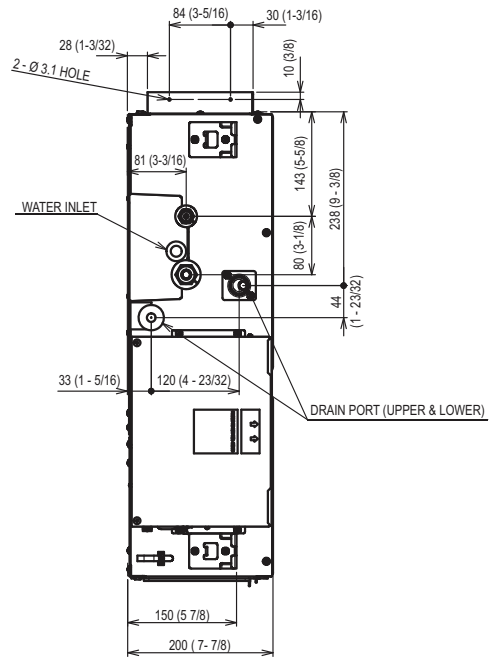

<Back View>

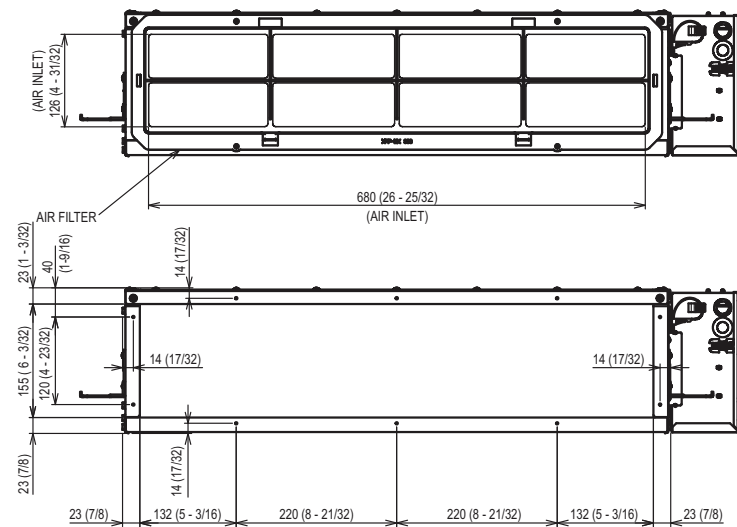

<Remote Control>

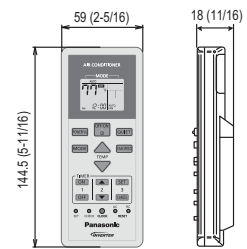

<Remote Control Holder>

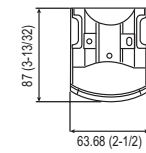

Unit : mm/inch

General Data	
<b>Power (V/P/Hz)</b>	<b>230/208/1/60</b>
Circuit Ampacity (A)	20
Fuse Size, Max.(A)	25
<b>Compressor</b>	
	DC Twin Rotary (Inverter)
No. Used	1
Motor Type (No. of poles)	DC Brushless (4 poles)
Output Power (W)	1.70K
<b>Outdoor Unit</b>	
Fan Type	Propeller
No. Speeds	Variable speed
Type Drive	Direct / DC Motor
No. Poles (RPM)	8/700
No. Motors (W)	1/60
CFM (Hi speed)	1925
Coil Type	Aluminum Fin Blue Coated
Fin Type - Pipe Type	Corrugated Fin
Rows x stage x F.P.I.	2 X 36 X 19
Size (W x H x L) mm	36.4 X 756 X 869
<b>Indoor Unit</b>	
Fan Type	Sirocco
Motor Type, No. of Poles	DC Brushless 8 poles
No. Speeds	5
RPM (Cool / Heat), High	1
No. Motors (W)	NA
CFM (Qlo/Lo/Me/Hi/SHi) Cooling	342/364/452/540/558
CFM (Qlo/Lo/Me/Hi/SHi) Heating	342/364/452/540/558
Operating Sound-H/L/QLo/ dB-A (Cool)	41/30/27
Operating Sound-H/L/QLo/ dB-A (Heat)	41/32/29
Max External Static Pressure	0.22 WG
Coil Type	Aluminum (Pre Coat)
Fin Type	Slit Fin
Row x stage x FPI	3 x 12 x 18
Size mm	590 x 282 x 38.1
Drain Connection Size Inner Diameter (in.)	5/8
<b>Refrigerant</b>	
	R410A
OZ. - R410a (outdoor unit)	56.5
Refrigerant Control	Electronic Expansion Valve
Refrigerant Tubing Connections	Flare
Line Length, Max (ft.)	100'
Elevation Difference, Max (ft.)	49.2
Line Size (in. O.D. Discharge)	1/4"
Line Size (in. O.D. Suction)	1/2"
Pre-charge, tubing length at shipment	32'.8"

Dimensions (HxWxD)		
Indoor Unit (Uncrated) (in.)	7-7/8 X 29-17/32 X 25-7/32	
Outdoor Unit (Uncrated) (in.)	31-5/16 X 34-15/32 X 12-5/8	
<b>Weight (lbs.)</b>		
(Indoor) Net	42lb	
(Outdoor) Net	132LB	
<b>Performance Data @ ARI Standard Conditions</b>		
<b>High Heating @47° (BTU/H)</b>	NA	
<b>Low Heating @17° (BTU/H)</b>	NA	
<b>Cooling</b>		
Total Capacity (BTU/H)	17,200(5,800-19,400)	
Sensible Capacity (BTU/H)	17,698	
Latent Capacity (BTU/H)	1,751	
SEER	16.50	
Dehumidification (Pints/H)	4.6	
Amps (A)	4.2	
Power Input (W)	1,580	
Outdoor Sound Rating (dB-A)	51	
<b>Heating</b>		
Total Capacity (BTU/H)	20,800(5,800-24,200)	
HSPF	8.50	
Amps (A)	8.7	
Power Input (W)	1,830	
Outdoor Sounds Rating (dB-A)	51	
<b>Features</b>		
Controls	Microprocessor	
Remote Controller	Wireless With Receiver Included	
Wired Remote Controller	Optional	
Temperature Control	IC Thermistor	
Timer	Single Event Daily ON/OFF TIMER	
Quiet mode	Included	
High Power mode	Included	
Air Louver, Horizontal	NA	
Air Louver, Vertical	NA	
Power Failure Automatic Restart	Built-In	
Heating/Cooling Automatic Changeover	Built-In	
Self-Diagnosis	Built-In	
Air Filter	Washable	
Operating Range	Indoor Air Intake Temp	Outdoor Air Intake Temp
Cooling	Max	89.6F DB / 73.4F WB
	Min	60.8F DB / 51.8F WB
Heating	Max	86.0F DB
	Min	60.8DB
		114.8F DB / 78.8WB
		0F DB / -/-
		75.2F DB / 64.4F WB
		-4.0F DB/-5.8F WB

